



Centrifugal Blowers

MARS SERIES **079**



**50752-D500,
50752-D230**

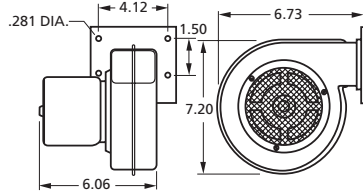

Uses model 1-6042 wheel



A159

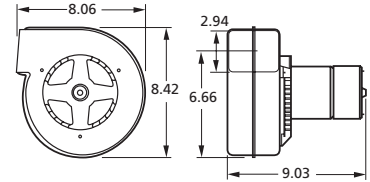

Uses model 1-6053 wheel

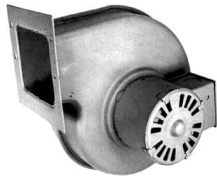

**50755-D500,
50755-D230**

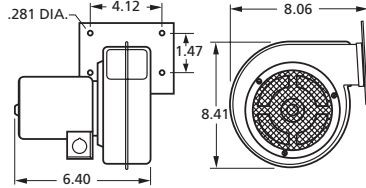

Uses model 1-6054 wheel



A161

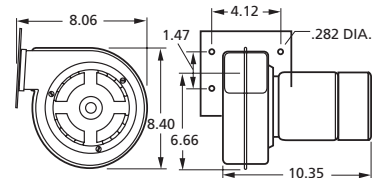

Uses model 1-6053 wheel



B47120

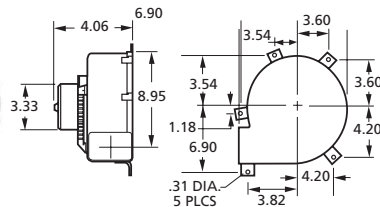

Uses model 1-6066 wheel



A212

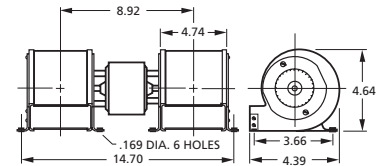

B45227, B45227-2

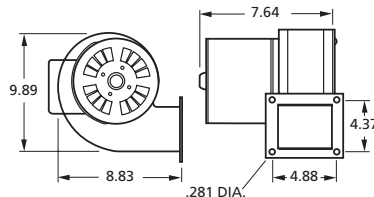

MODEL#	CFM AT STATIC PRESSURE SHOWN										NAME-PLATE CFM	VOLTS	FREQ.	NO. OF SPEEDS	RPM@ FREE AIR	AMPS@	
	STATIC PRESSURE (INCHES OF WATER)															FREE AIR	BRNG
	0.1	0.2	0.3	0.4	0.5	0.6	0.7	0.8	0.9	1							
50752-D500	108	105	97	93	90	83	77	65	32	—	135	115	60	1	3100	1.1	SLV
50752-D230	108	105	97	93	90	83	77	65	32	—	135	208-230	50/60	1	3100	.67	SLV
B160	135	130	115	100	75	20	—	—	—	—	150	115	60	1	3000	1.56	SLV
A159	140	138	118	105	—	—	—	—	—	—	159	230	60	1	1600	.45	BALL
50755-D500	140	128	118	105	—	—	—	—	—	—	160	115	60	1	1600	1	SLV
50755-D230	140	128	118	105	—	—	—	—	—	—	160	208-230	50/60	1	1600	.51	SLV
A161	140	138	118	105	—	—	—	—	—	—	161	230	60	1	1600	.55	BALL
B47120	180/144/112	170/140/109	165/134/106	158/130/100	150/122/90	140/117/76	130/87/58	110/72	90	—	180	115	60	3	1360/1100/830	1.95	SLV
A212	190	173	142	110	70	22	—	—	—	—	212	115	60	1	2500	1.25	SLV
B45227	230	212	191	175	130	27	—	—	—	—	265	115	60	1	1650	1.86	SLV
B45227-2	230	212	191	175	130	27	—	—	—	—	265	230	50/60	1	1650	.93	SLV

FASCO